

LOW CAPACITY 'S' BEAM TENSION SENSORS



HI STS 'S' Beam Type Tension Load Sensors

The Hardy Process Solutions HI STS beam type nickel plated alloy tool steel sensor is designed for low capacity hanging vessels, hoppers, filling machinery and process control. These sensors feature IP67 ratings, and improved potting makes them suitable for use in industrial environments. They are available in capacities from 25 lb to 200 lb (11 kg to 91 kg).

The sensor can be mounted standalone or using threaded rods.

SPECIFICATIONS	HI STS
Rated Output (ES)	3 ± 25% mV/V
Max # Verification Int.	5000
Zero Balance	< ± 1.0 % R.O.
Combined Error	< ± 0.03 % R.O.
Creep @ 30 Min.	< ± 0.03 % R.O.
Temp Effect Output	< ± 0.0010 % RO /°F
Temp Effect Sensitivity	< ± 0.0008 % load /°F
Input Resistance ohm	343 to 450
Output Resistance	349 to 355
Insulation Resistance	≥ 1000 Mohm
Excitation	5 - 15 vdc
Safe Load Limit	150 % Emax
Ultimate Load	300 % Emax
Sensor Material	Nickel Plated Alloy Steel
Sealing	Potted
Protection EN 60 529	IP67
Warranty	Two years

ORDERING INFORMATION

Shipping Weight HI STS 4lb; HI STA 2 lb.

Capacity		Sensor Model#
lb	kg*	HI STS
25 lb	11 kg	HISTS-25LB
50 lb	23 kg	HISTS-50LB
75 lb	34 kg	HISTS-75LB
100 lb	45 kg	HISTS-100LB
150 lb	68 kg	HISTS-150LB
200 lb	91 kg	HISTS-200LB

* kg calculated from lb capacities

HI STS Sensor

DIMENSIONS- INCHES & [mm]

MODEL NUMBER	CAPACITY LB	MOUNT THD	WEIGHT LB [KG]
HI STS-25LB	25 LB	1/4-28 UNF-2B	4 LB [1.8KG]
HI STS-50LB	50 LB		
HI STS-75LB	75 LB		
HI STS-100LB	100 LB		
HI STS-150LB	150 LB		
HI STS-200LB	200 LB		

TOLERANCES: ±0.01 [0.3] UNLESS OTHERWISE STATED

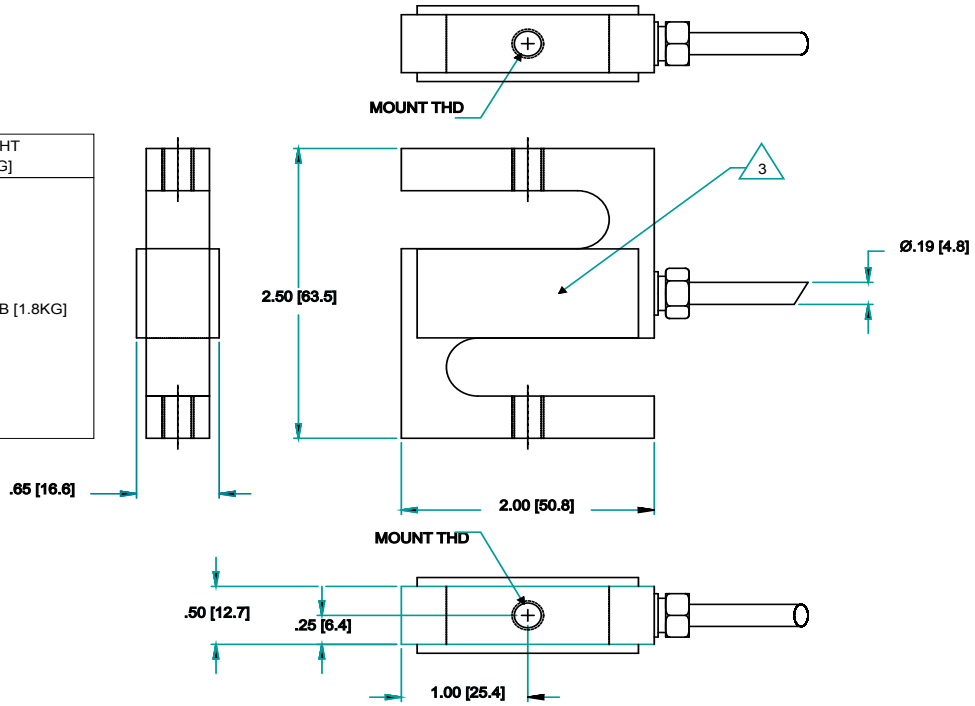

WIRE COLOR CODE

EXCITATION +	RED
EXCITATION -	BLACK
SIGNAL +	GREEN
SIGNAL -	WHITE

WARNING: NEVER cut load sensor cable

CABLE LENGTH 6 METERS (APPROX. 20 FT.)